

The GoTo™ FOLDING INFANT CAR SEAT STATION FOR HOME AND AWAY

Read all instructions BEFORE assembly and USE of product.
KEEP INSTRUCTIONS FOR FUTURE USE.

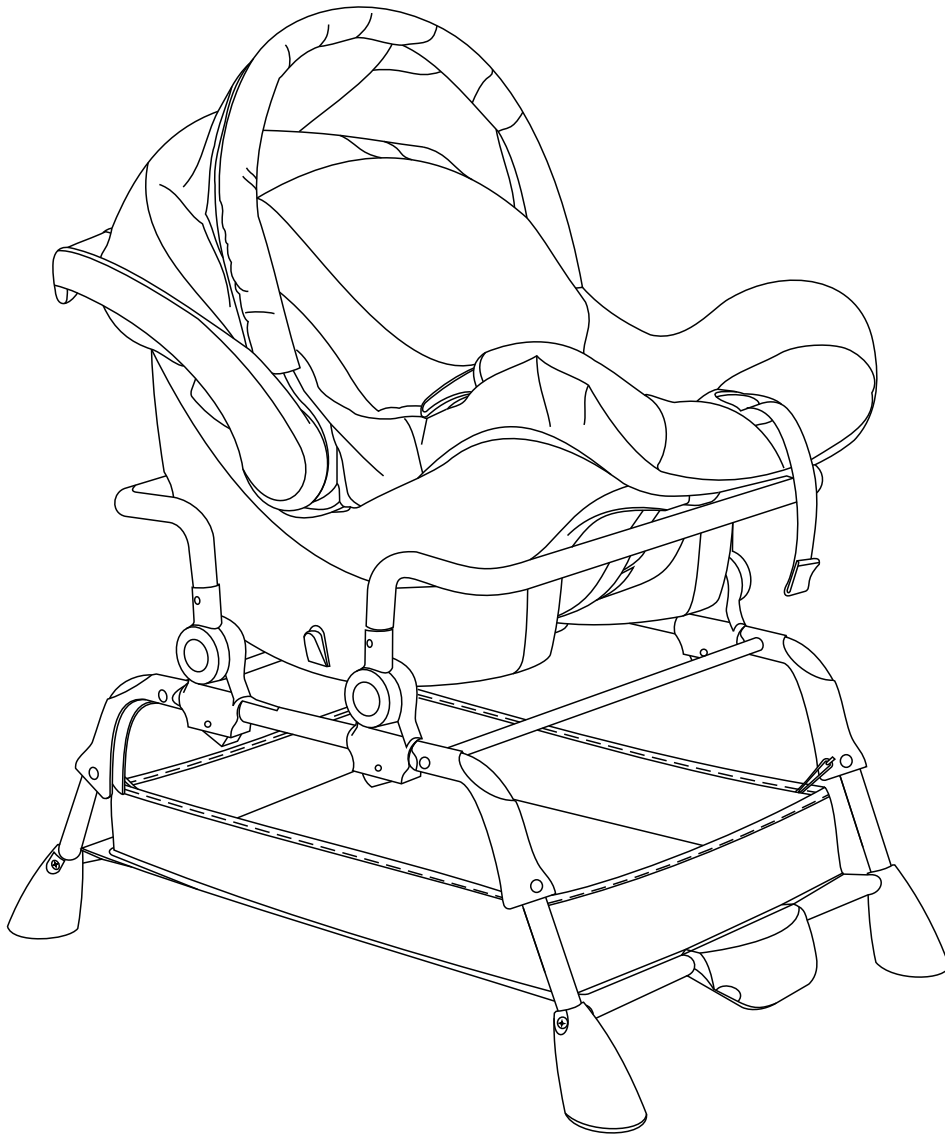

Remove product from the box and remove all packaging materials.
Caution: make sure to throwaway all packaging materials.

Make sure to inspect every part to make sure there are no broken or missing parts. If so, do not use and contact us!

MODEL # GT111003

A



⚠️ WARNING ⚠️

- ⚠️ **WARNING:** Please follow all of these instructions to ensure the safety of your child. Keep these instructions for future reference.
- ⚠️ **WARNING:** Adult assembly required.
- ⚠️ **WARNING:** Failure to follow these instructions could result in serious injury or death. Avoid serious injury from falling or sliding out, always use the safety harness and insure that the children are properly positioned according to these instructions.
- ⚠️ **WARNING:** Never leave children unattended.
- ⚠️ **WARNING:** Care must be taken when folding and unfolding the GoTo to prevent finger entrapment.
- ⚠️ **WARNING: Prevent serious injury or death from falls or sliding.** Always use seat belt. Secure your child at all times with the restraint.
- ⚠️ **WARNING:** This product is designed to be used by a child up to 3 years of age. Maximum weight 40 pounds (18kg).
- **Caution:** Be certain the GoTo is completely opened and locked in place before allowing a child near the product.
- Never use near steps or uneven surfaces.
- Never allow your GoTo to be used as a toy.
- Check your GoTo for loose screws, worn parts, torn materials or stitching on a regular basis. Replace or repair parts as needed.
- Discontinue use should it malfunction or become damaged. Please contact our customer care department to arrange for repair or obtain replacement parts if needed.
- If you experience any difficulty with the use of our product or have a question regarding these instructions, please contact our customer care department at **800-704-9058**.
- **To clean** use only mild household soap or detergent and warm water on a sponge or clean cloth.

Customer Care:

www.phoenix-baby.com

HARDWARE

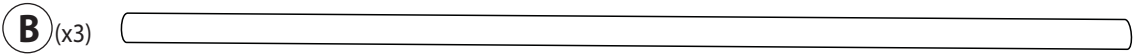
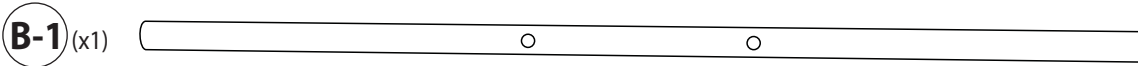
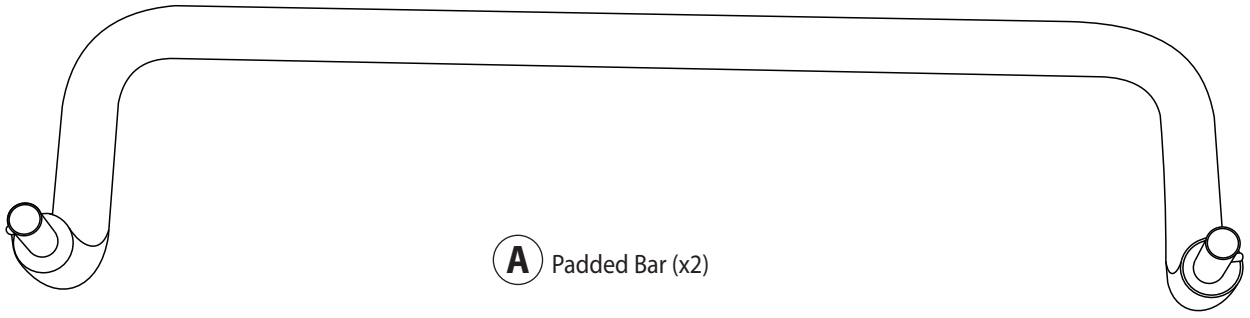

B Cross Bar (x4)

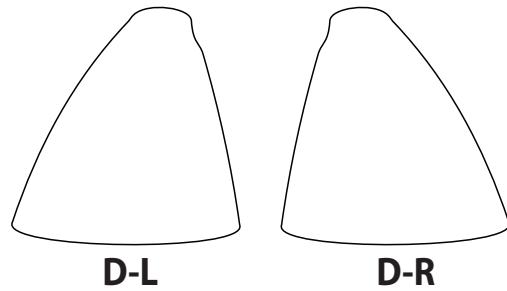
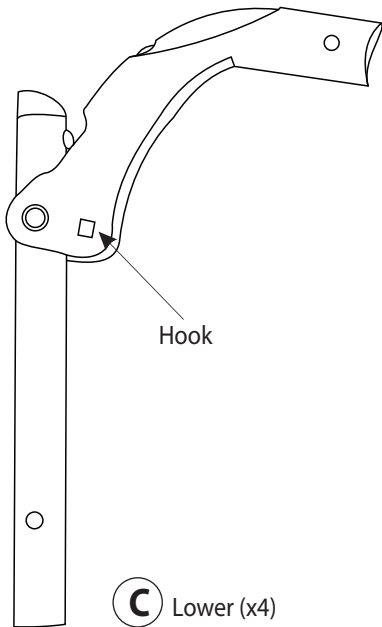

D Feet (x4)

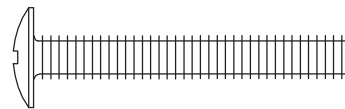

E Bolt (x8)

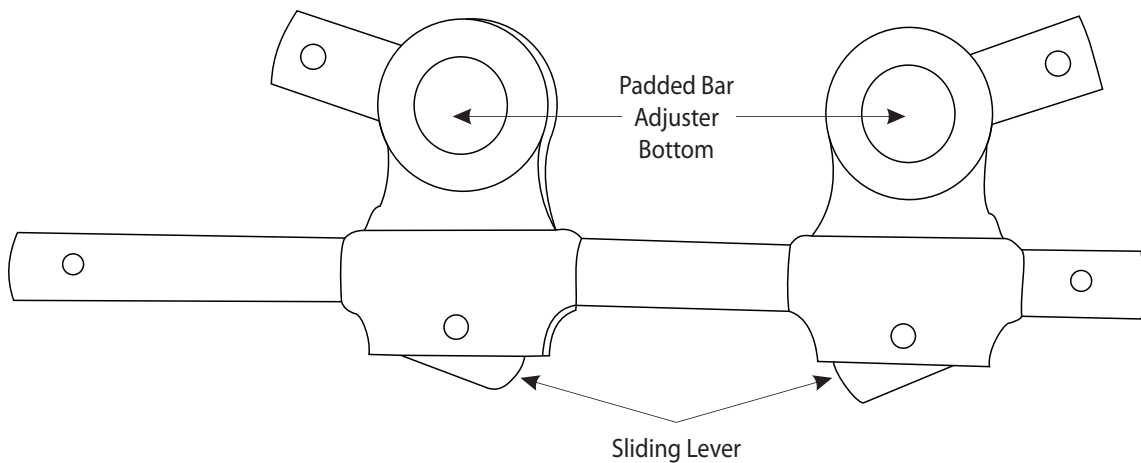

F Top Side (x2)

ASSEMBLY INSTRUCTIONS

1

STEP 1A

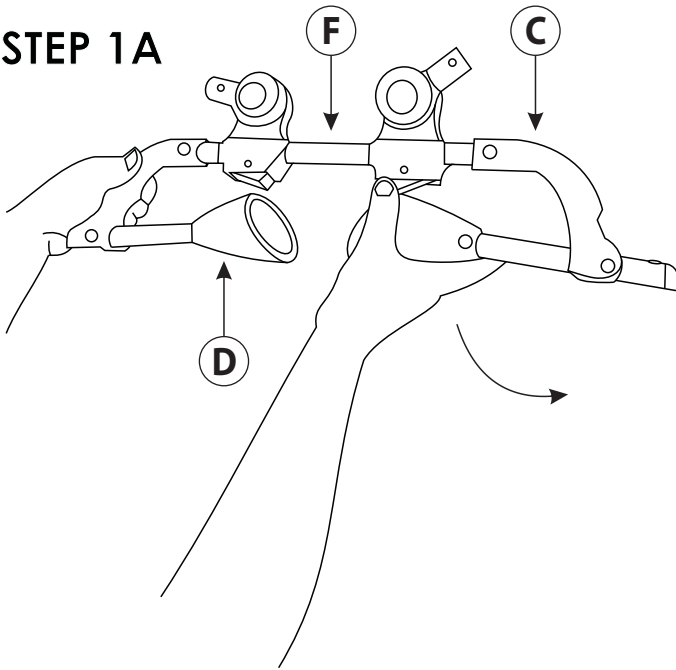

For ease of assembly your GoTo has been partially assembled.

If any of the parts come apart when you unpack the product from the box. Please turn to page 11.

STEP 1B

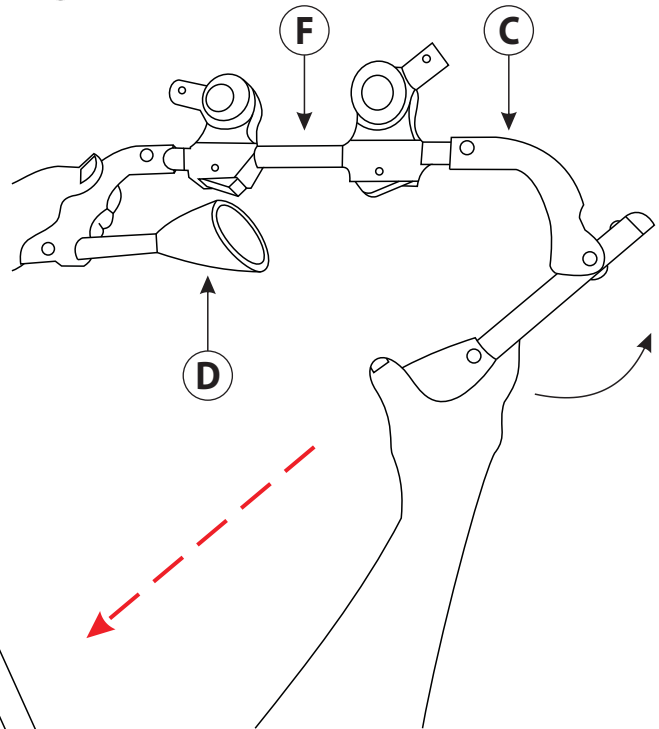

Grab the foot of the GoTo and rotate outward until it locks-as shown. Make sure fingers are not close to joint. Repeat with the 3 other legs.

STEP 1C

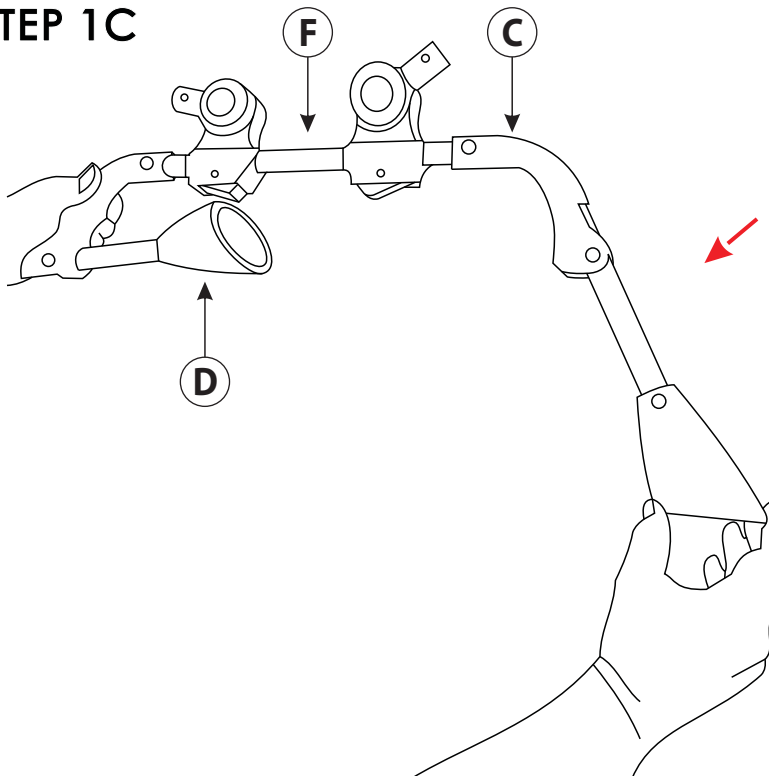

Warning : Avoid FINGER ENTRAPMENT : Use care when folding and unfolding the GoTo.

ASSEMBLY INSTRUCTIONS

2

When attaching the crossbars, one of the bars has 2 holes, make sure to place that bar thru 1 of the feet part B-1 in step 4.

Bolt bars in using the bolt part (E).

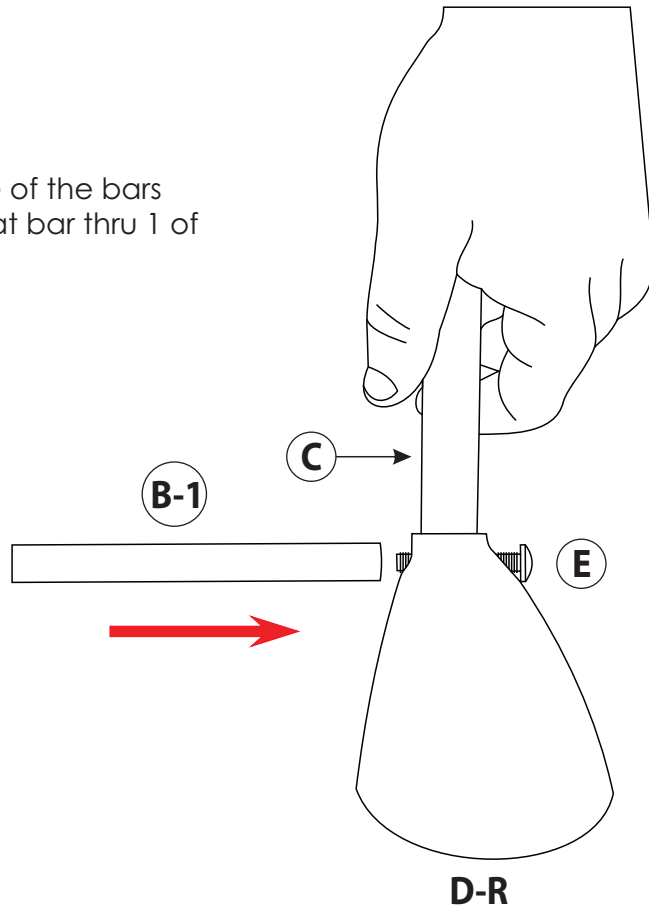

3

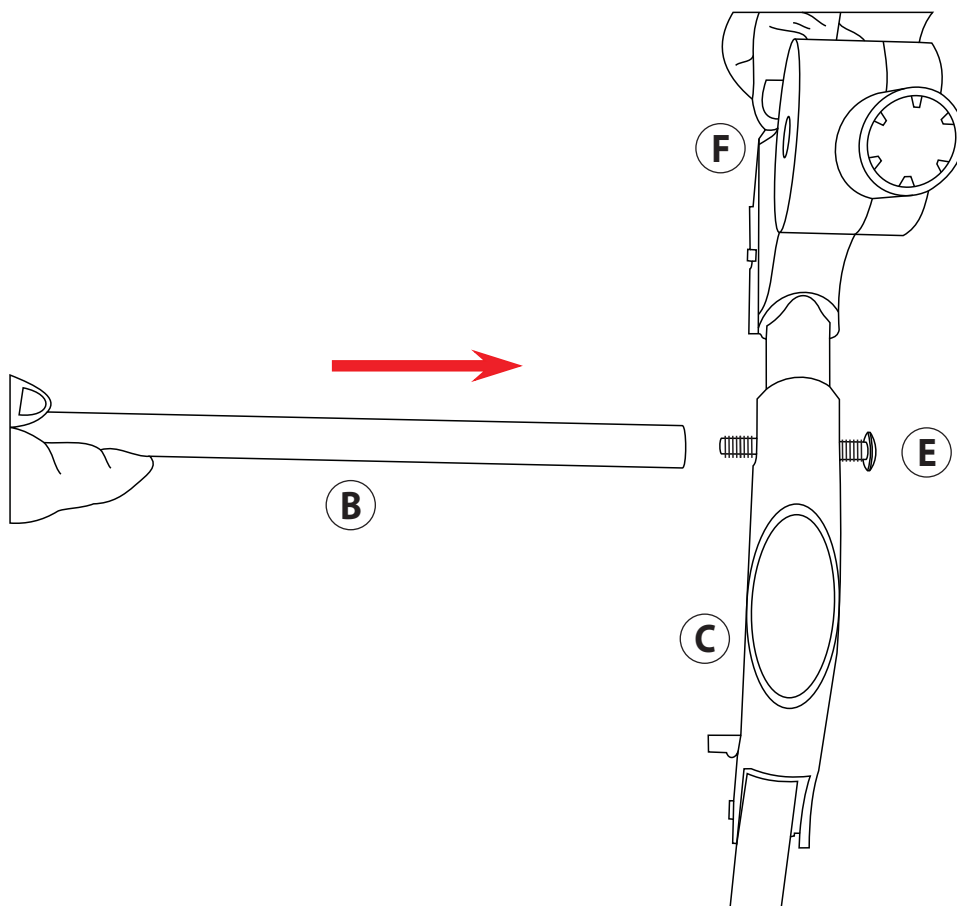

5

ASSEMBLY INSTRUCTIONS

4

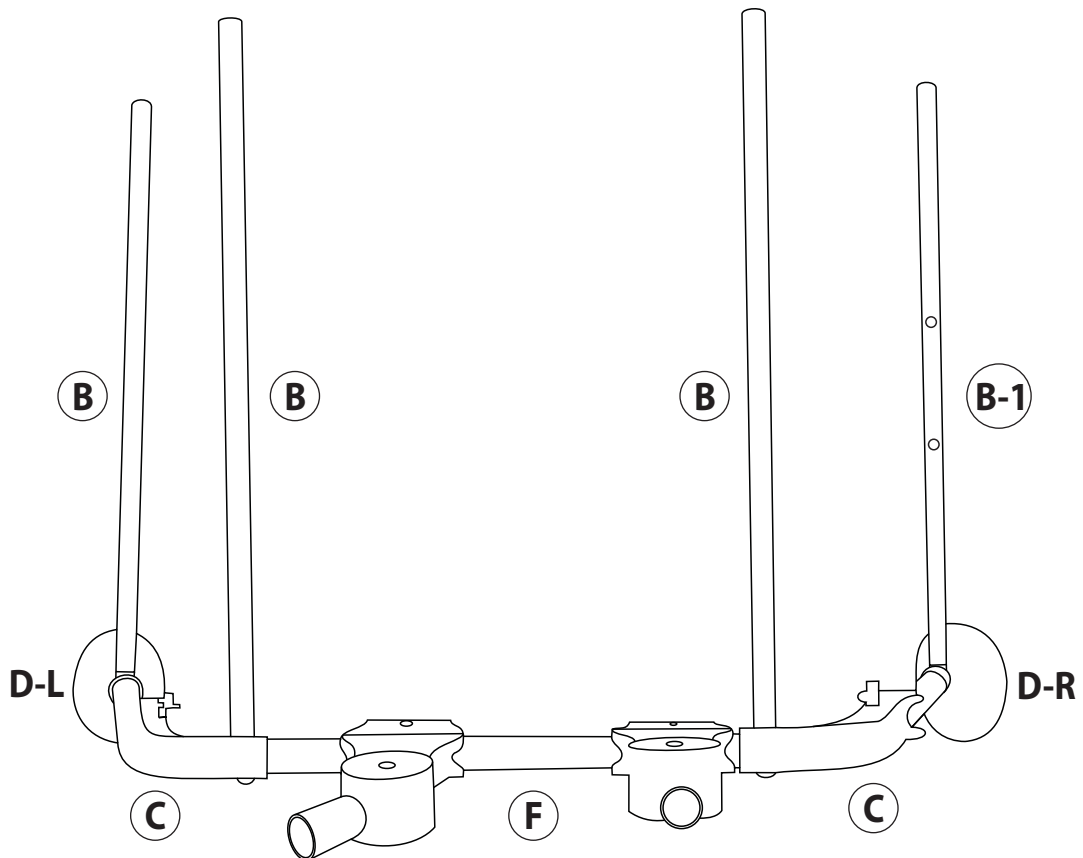

5

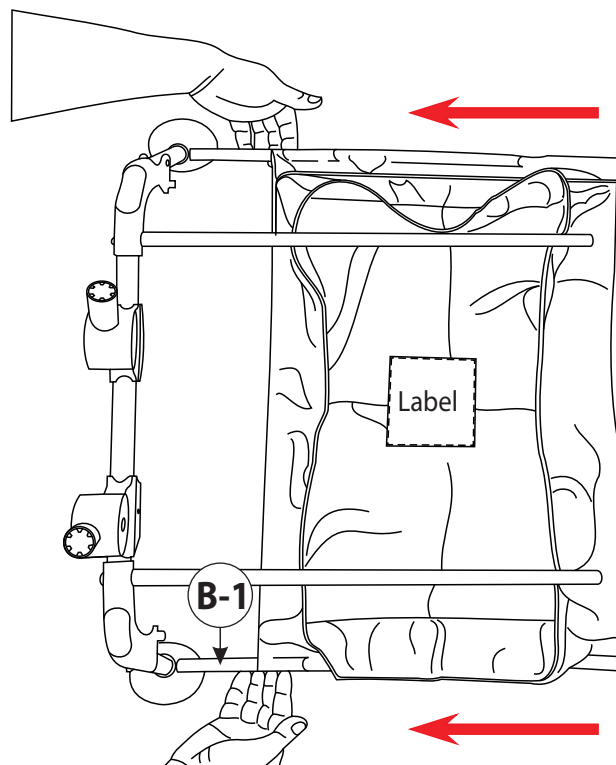

Line up the sleeve in the fabric and slide across the tubes. Make sure the cut out area in the fabric lines up with B-1 so that the vibrator can be attached.

6

ASSEMBLY INSTRUCTIONS

6

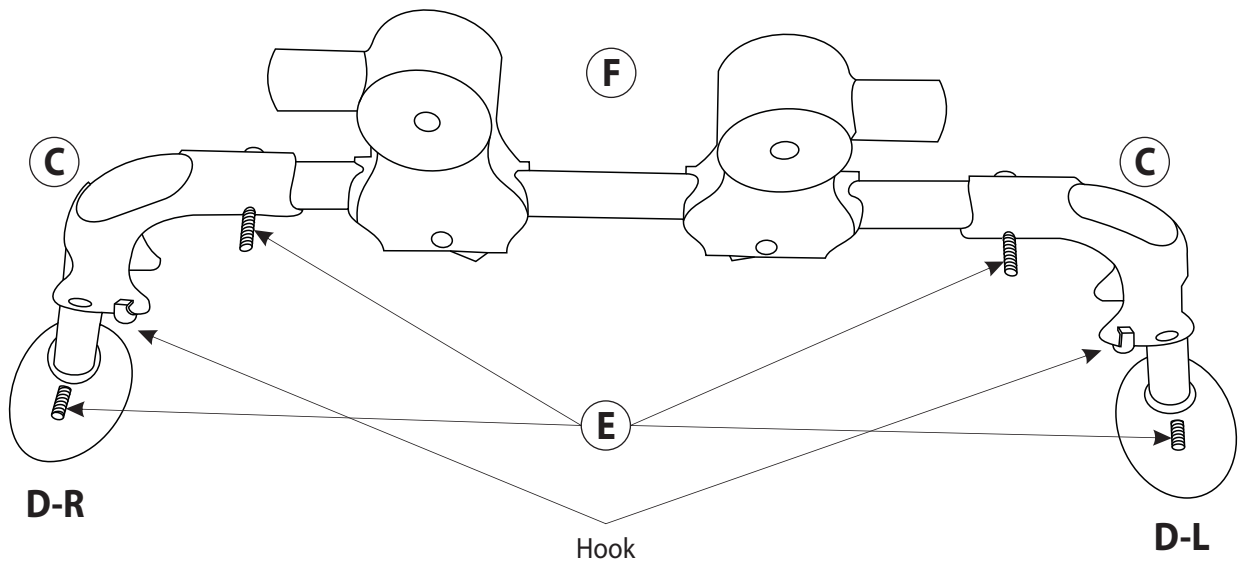

Attached second side to unit using bolts (E).

7

Make sure to tighten all bolts (E).

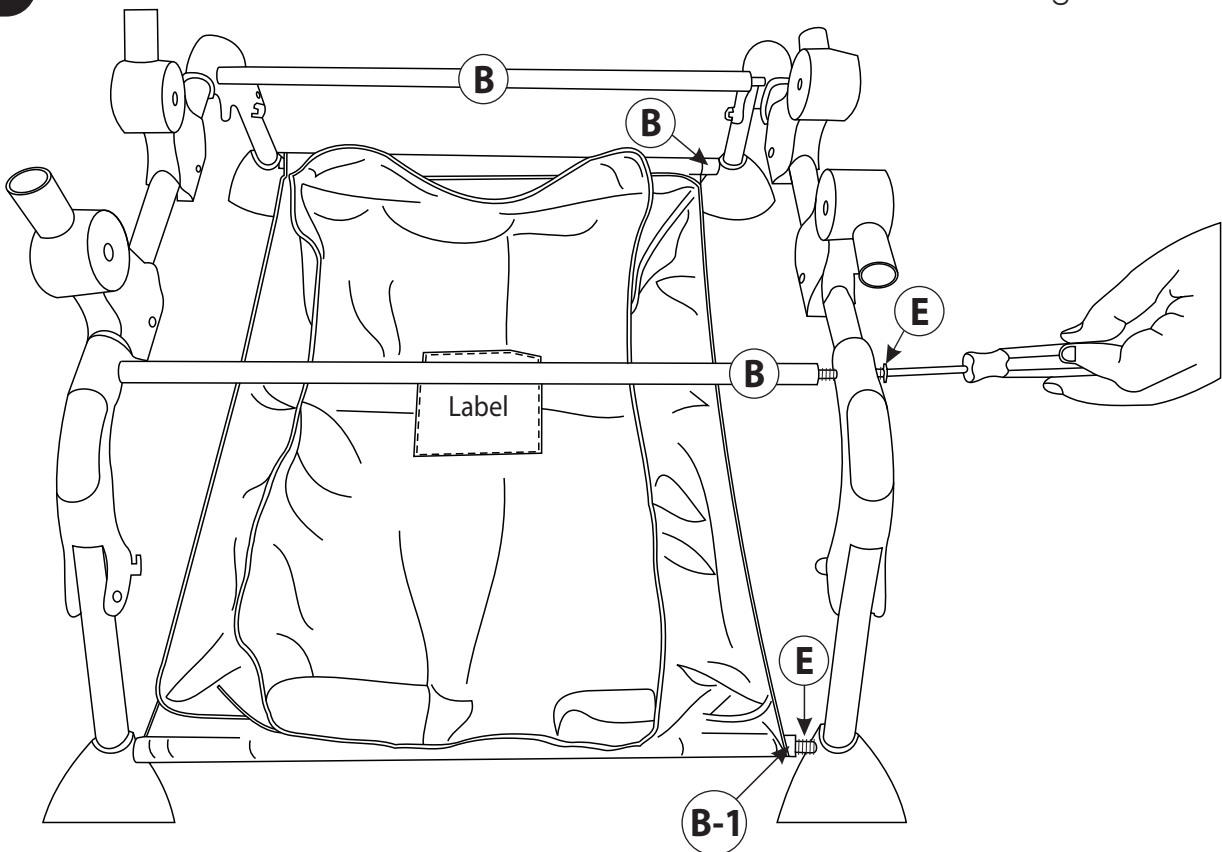

7

ASSEMBLY INSTRUCTIONS

8

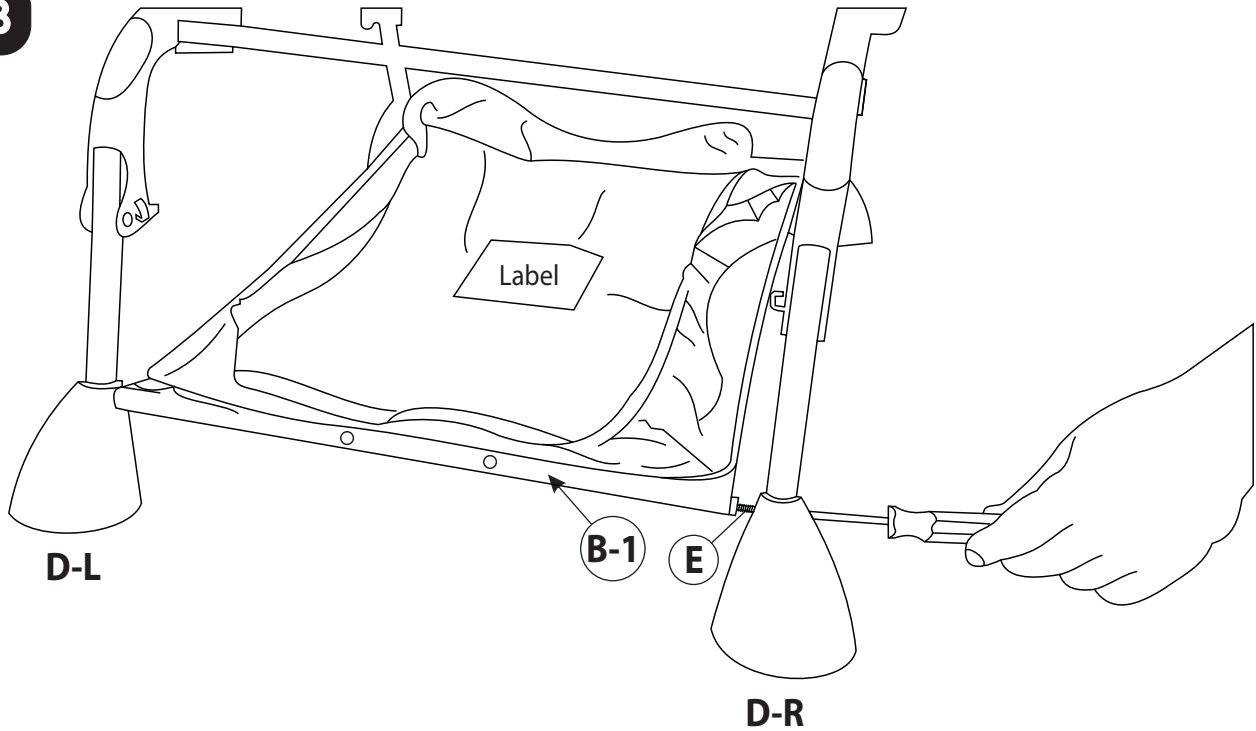

9

1. Make sure the 4 adjusters are pointing up. If you need to adjust them, push in the adjuster button and rotate til pointing up.
2. Make sure all adjusters line up, you may need to slide them as shown to line up. Push in slider level to move.

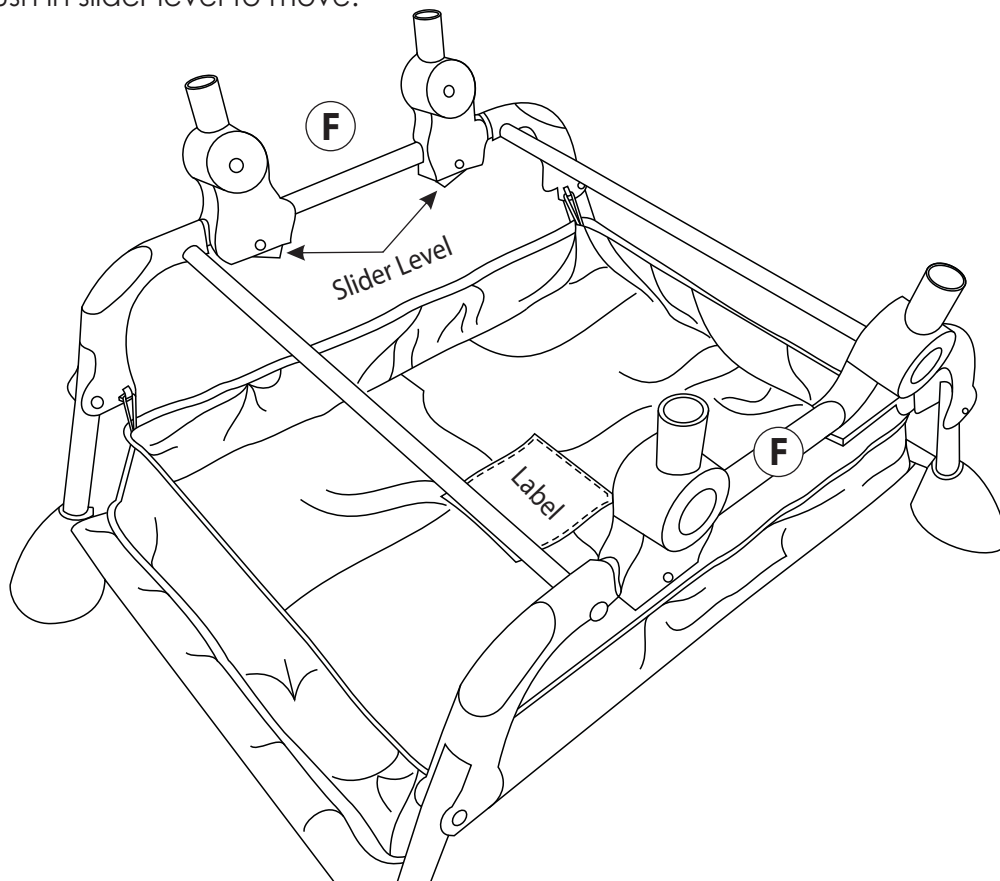

8

ASSEMBLY INSTRUCTIONS

10

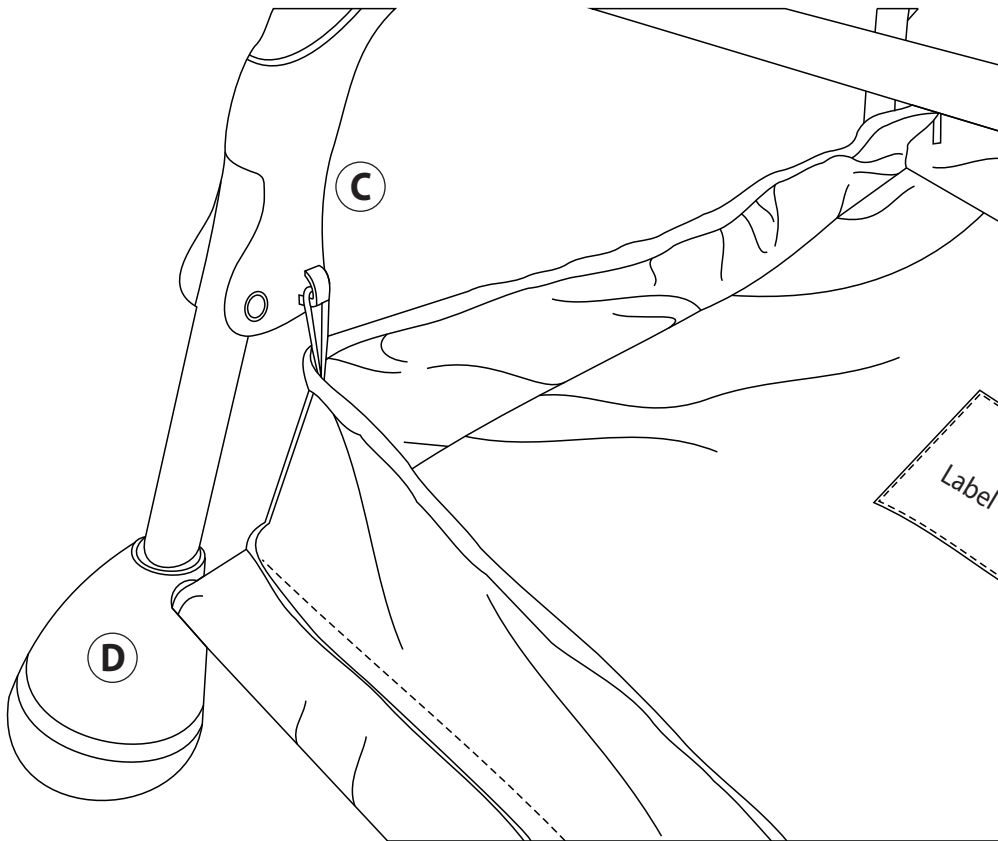

Attach the 4 elastic loops on the fabric basket to the 4 hooks on the lower legs.

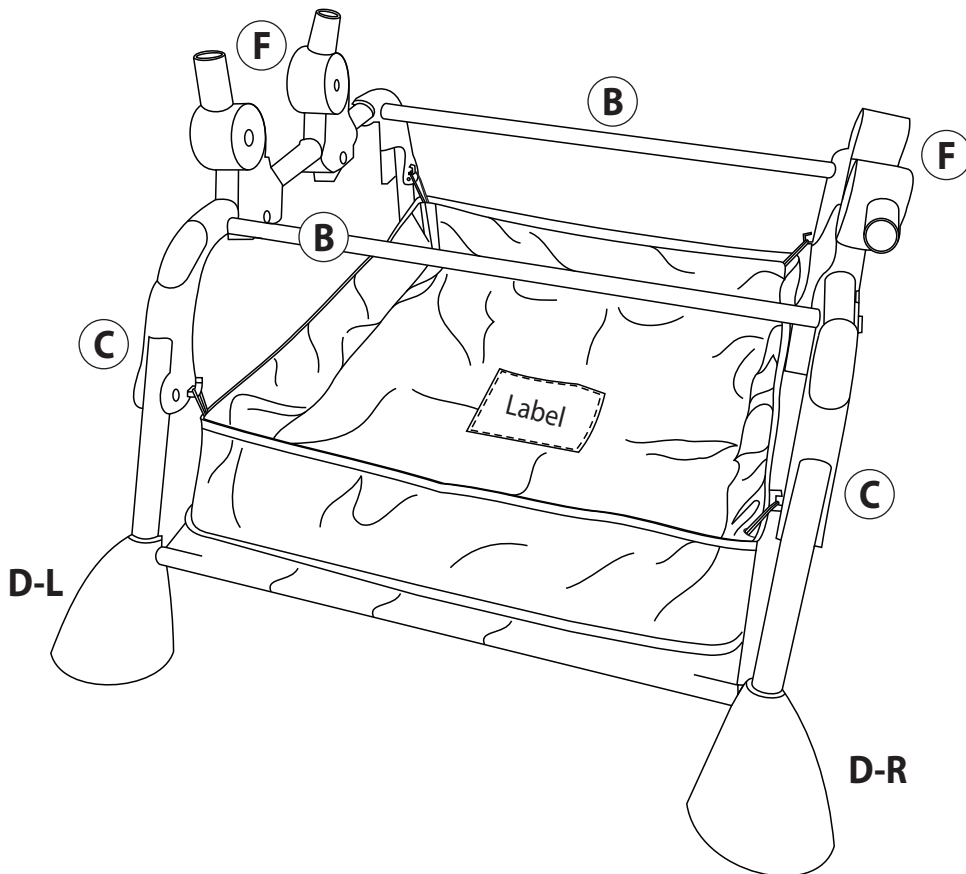

9

ASSEMBLY INSTRUCTIONS

11

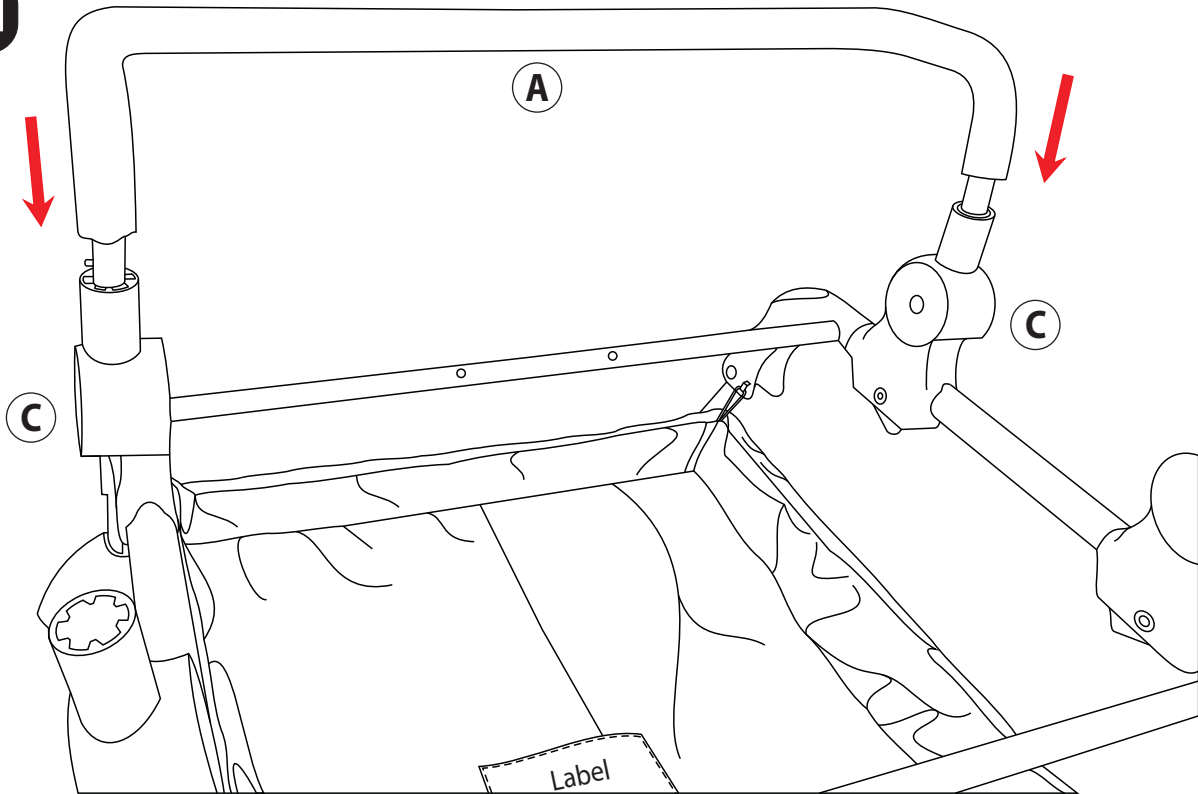

Push padded Bar (A) down until it locks in the down position.
Pull up to make sure part (A) is locked down.
Repeat on other slide with part (A)

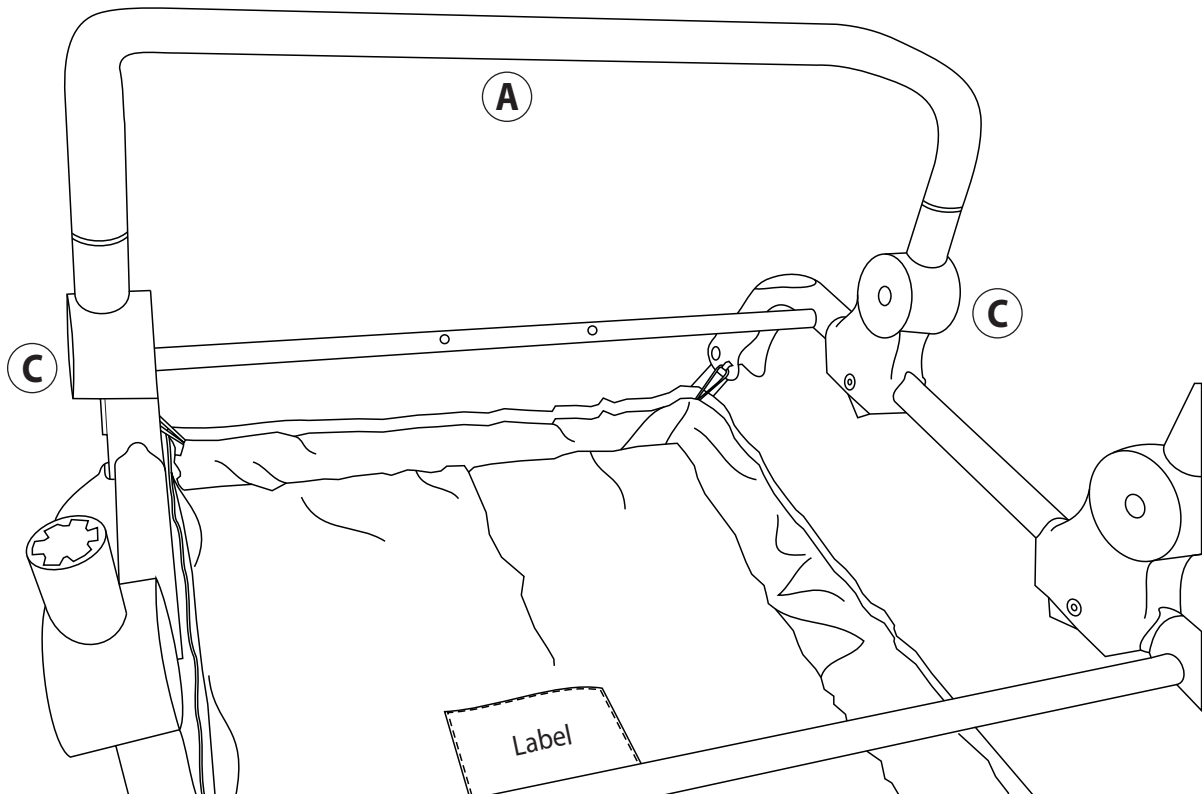

10

ASSEMBLY INSTRUCTIONS

If a part has separated when they were unpacked. Please follow this steps. Then go to back page.

1

Slide feet part (D) onto lower leg (C) and insert bolt (E) thru feet part (D)
Note: there are right and left sides to the feet
Make sure you match the part to the photo.

Repeat on all 4 feet.

Make sure all 4 feet are flush to the floor-as shown.

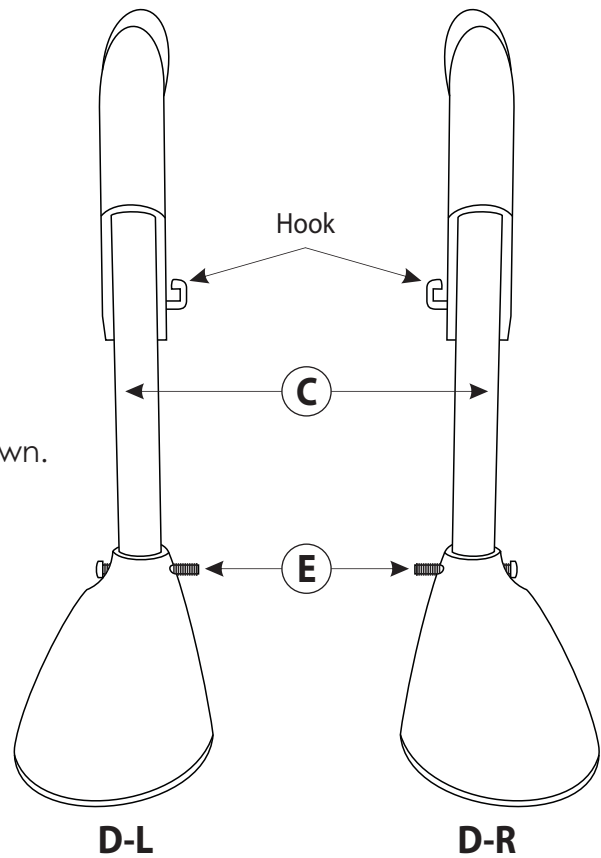

2

Make sure hook is facing in and the adjuster button is facing out.

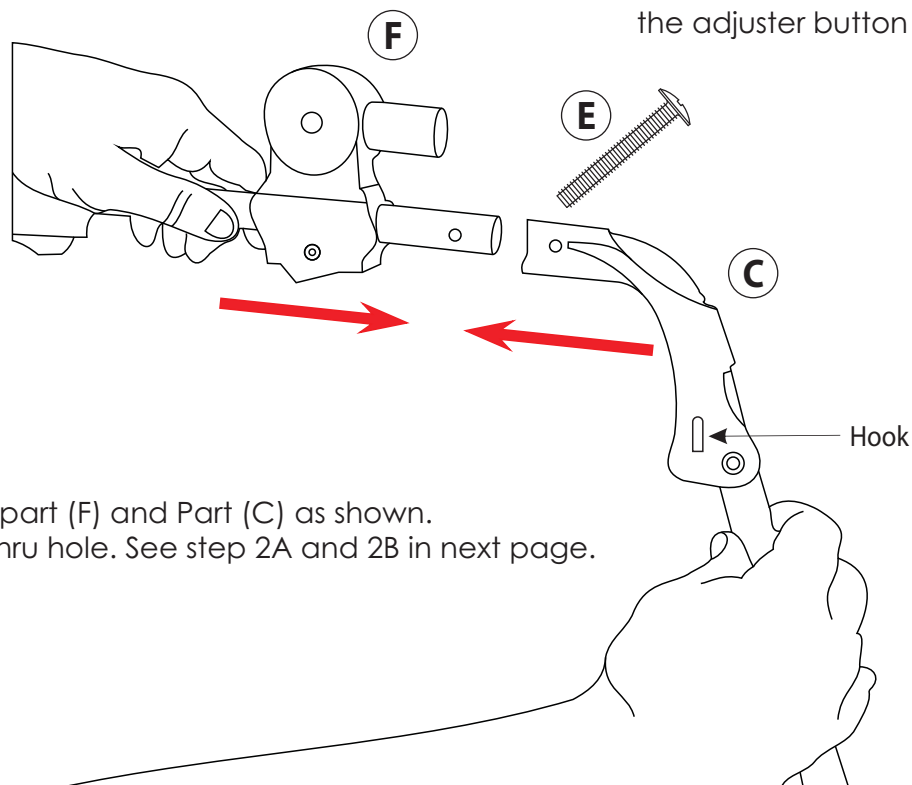

Slide together part (F) and Part (C) as shown.
Insert bolt (E) thru hole. See step 2A and 2B in next page.

ASSEMBLY INSTRUCTIONS

2A

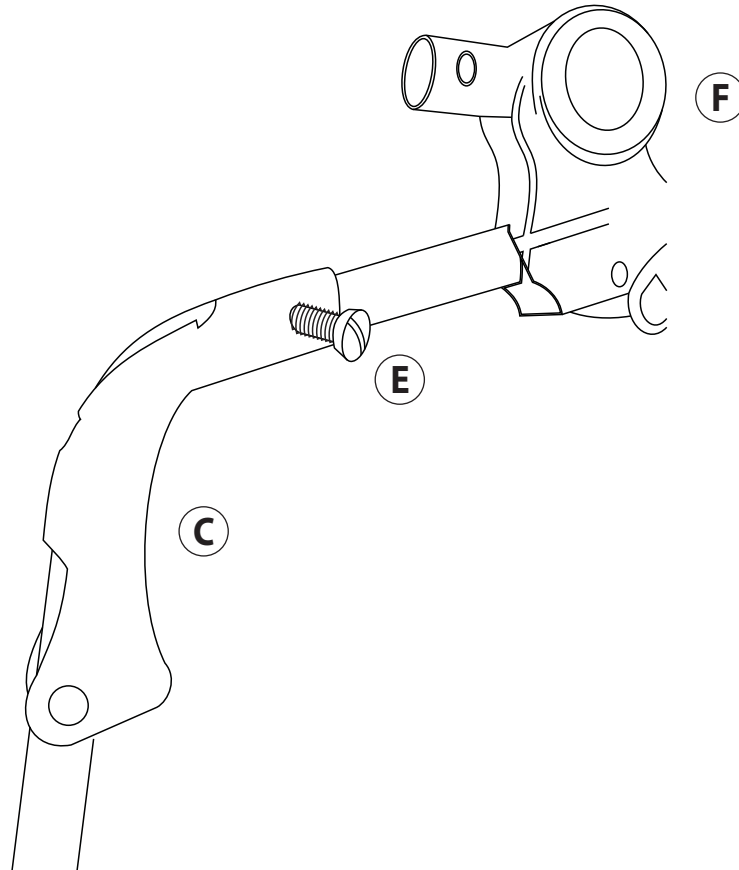

3A

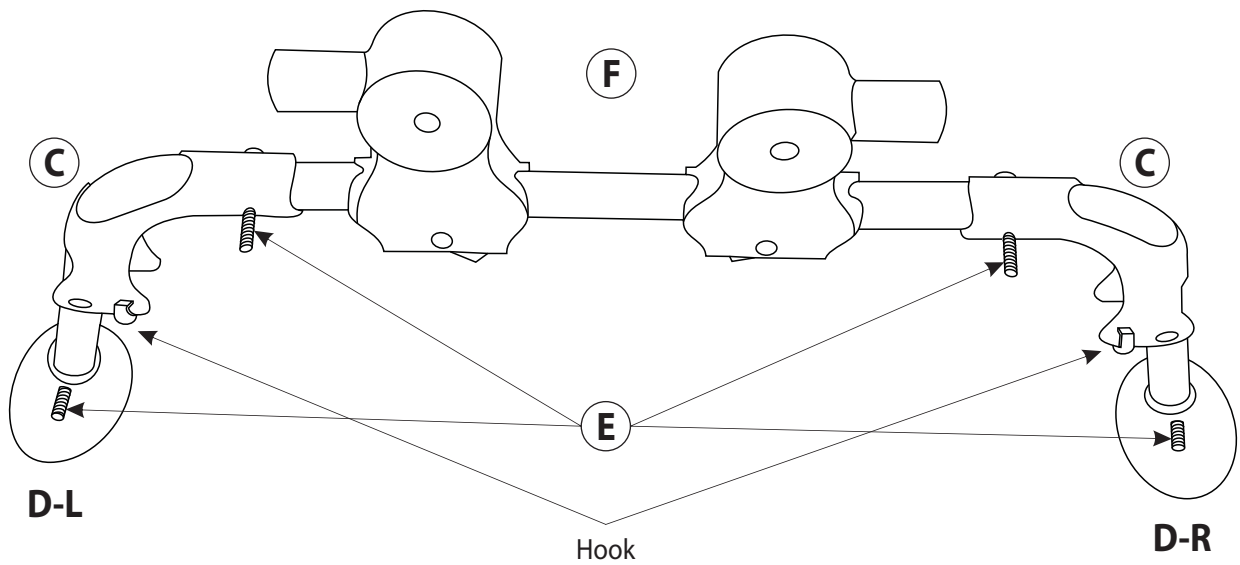

ASSEMBLY INSTRUCTIONS

1

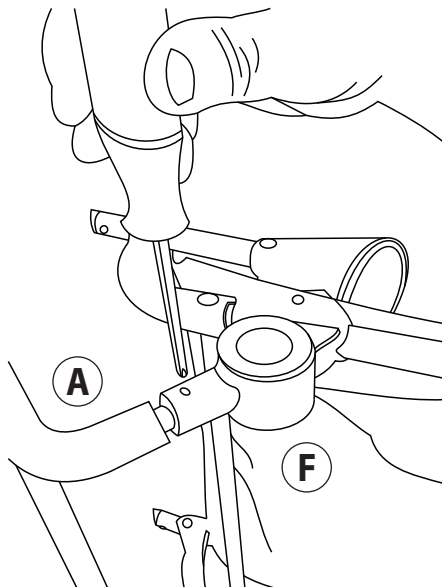

2

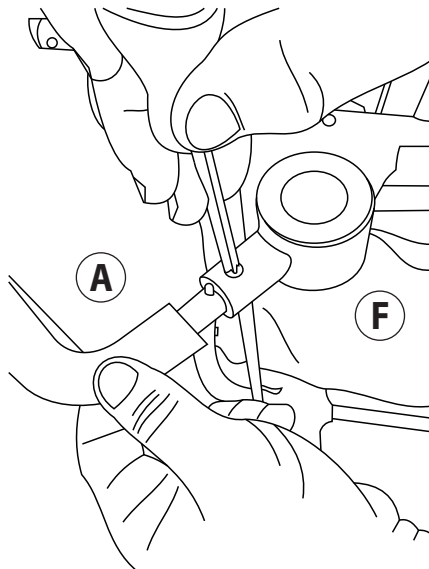

3

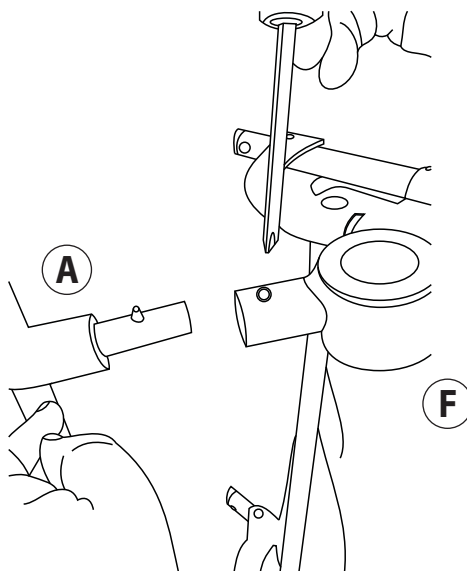

TO FOLD

1

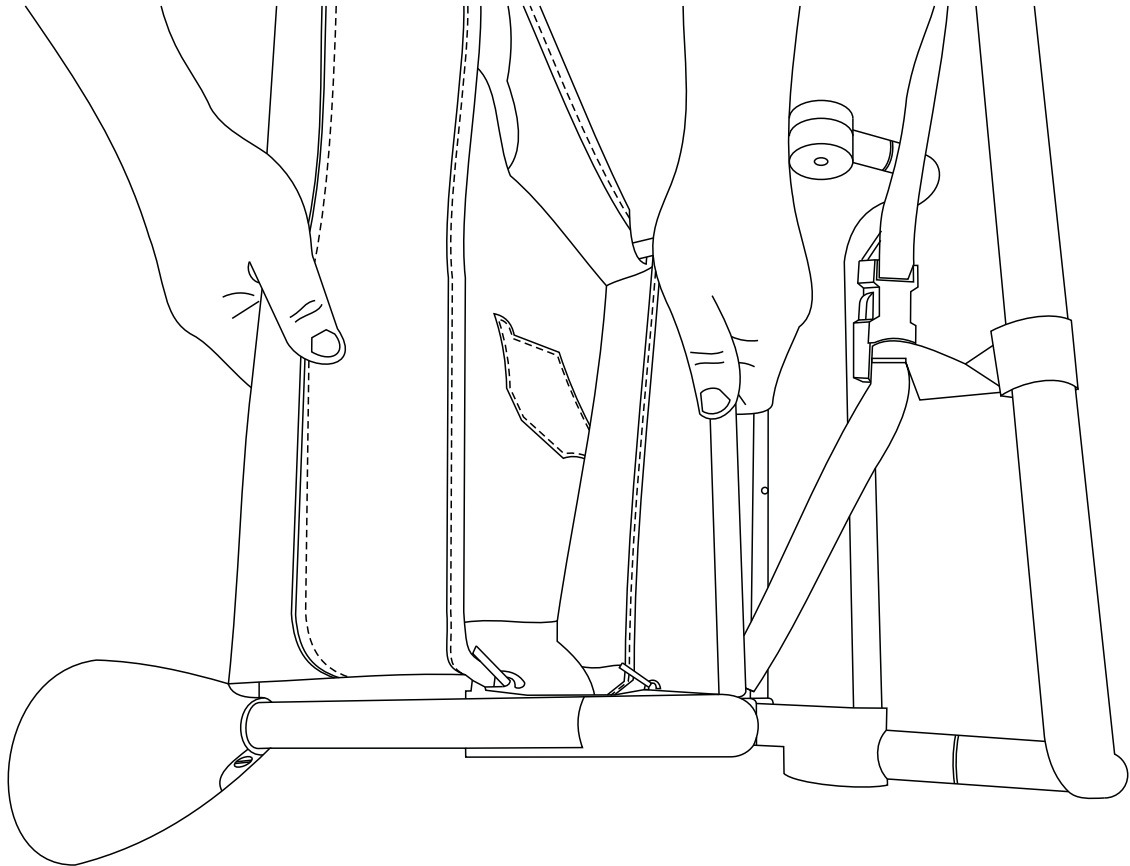

2

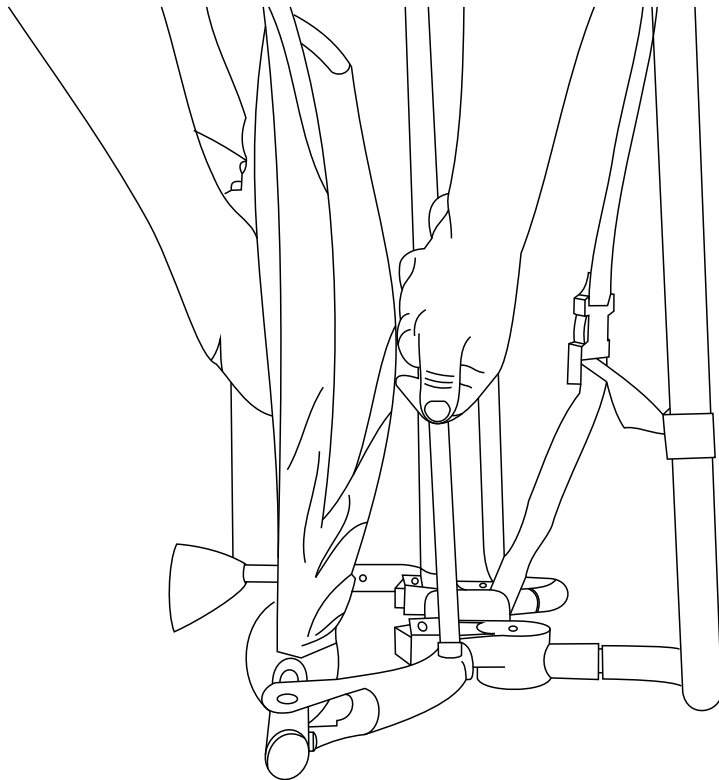

Pull down on the lower bar (B) until the 2 legs separate from part (F). Continue to fold legs until they are underneath – as shown, repeat on other side.

TO FOLD

3

Push in Adjuster button and rotate padded bar down—as shown

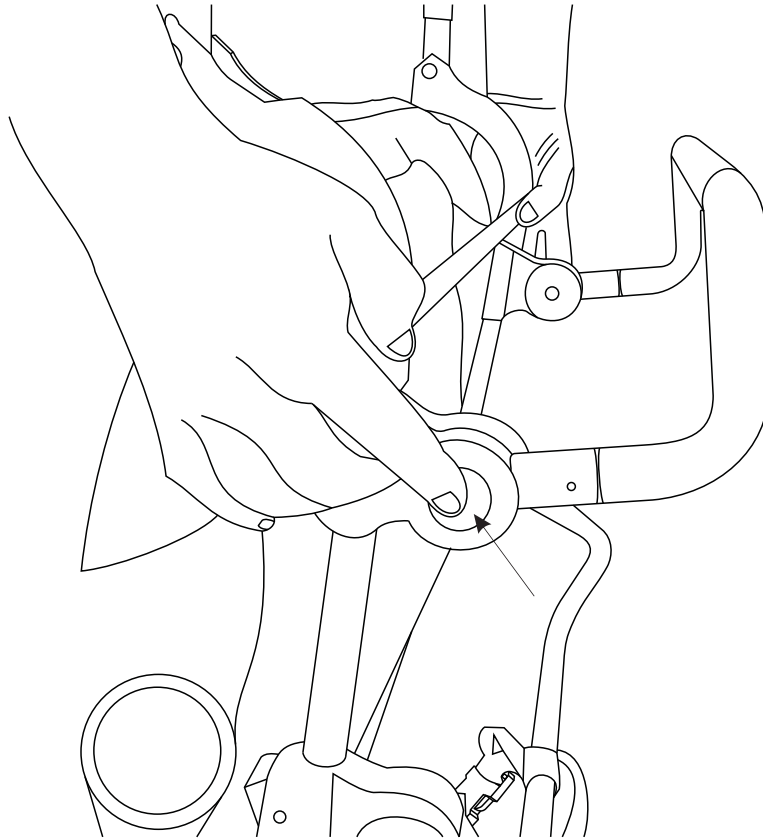

4

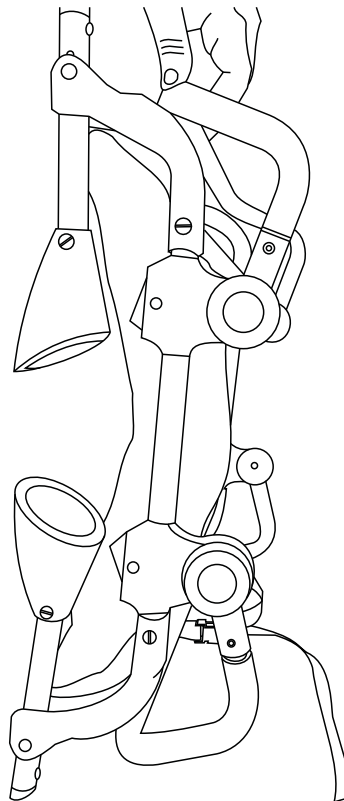

Warning: AVOID FINGER ENTRAPMENT: Use care when folding and unfolding. Make sure no children are near.

PRODUCT REGISTRATION

IMPORTANT: Please fill in your contact info on the bottom part of the card, separate from top card and mail to us. Note, postage is prepaid if mailed in the United States. Keep the top portion for your records. This information is important to us should we need to contact you regarding the safety of this product.

**PRODUCT REGISTRATION FOR
SAFETY ALERT OR RECALL ONLY
ENREGISTREMENT DU PRODUIT POUR
ALERTE DE SÉCURITÉ OU RAPPEL UNIQUEMENT**

We will use the information provided on this card to contact you only if there is a safety alert or recall for this product. We will not sell, rent, or share your personal information. To register your product, please complete and mail the bottom part of this card, or visit our online registration at:
www.phoenix-baby.com

Nous utilisons les informations fournies sur cette carte pour vous contacter que si il ya une alerte de sécurité et le rappel de ce produit. Nous n'allons pas vendre, louer, ou partager vos informations personnelles. Pour enregistrer votre produit, s'il vous plaît remplir et poster la partie inférieure de cette carte, ou visitez notre inscription en ligne à l'adresse:
www.phoenix-baby.com



NO POSTAGE
NECESSARY
IF MAILED IN THE
UNITED STATES
AUCUN AFFRANCHISSEMENT
NECESSAIRE
S'IL EST POSTÉ DANS LE
ÉTATS-UNIS

BUSINESS REPLY MAIL
FIRST-CLASS MAIL PERMIT NO. 182 ALLENTOWN PA

POSTAGE WILL BE PAID BY ADDRESSEE

Phoenix Baby, LLC.
c/o RBO, LLC.
PO BOX 91058
ALLENTOWN PA 18109-9917



Front

**Manufacturer's Contact Information/Coordonnées du fabricant
Phoenix Baby, LLC. (c/o RBO, LLC.)
501 S 9TH Street, Reading, PA 19602 USA
Customer Care: 1-800-704-9058
E-Mail: customercare@phoenix-baby.com
www.phoenix-baby.com**

Product Model/Modèle de produit#: _____

Shipment Ref./Réf. d'Expédition#: _____

Manufacture Date/date de fabrication: _____

**KEEP THIS TOP PART FOR YOUR RECORDS.
FILL OUT AND RETURN BOTTOM PART.
GARDER CETTE PARTIE SUPÉRIEURE POUR VOS DOSSIERS.
REPLIR ET RENOVOYER PARTIE INFÉRIEURE.**

Name/nom

Mailing Address/Mailing Address

City/ville _____ **State/état** _____ **Zip Code/Code postal** _____

Telephone Number/numéro de téléphone
____-____-____

E-mail Address/Adresse E-mail

Product Model/Modèle de produit#: _____

Shipment Ref./Réf. d'Expédition#: _____

Manufacture Date/date de fabrication: _____

Back

PRODUCT PACKAGING INFORMATION



**501 S 9th street,
Reading, PA 19602 USA
www.phoenix-baby.com**

MADE IN CHINA

Model #: GT111003

Color: _____

Shipment Ref. #: _____

Date: _____